

OVERLAY MEMBRANE EDGES WITH 6" PRESSURE-SENSITIVE CURED COVER STRIP

\* IF SELVAGE EDGE IS PROVIDED ON FLEECEBACK MEMBRANE USED AS FLASHING (AT BASE OF WALL), FOLLOW SPLICE PROCEDURES OUTLINED ON DETAIL FB-15-C.

1. SEAL ALL EDGES WITH LAP SEALANT.
2. FOR USE OF SURE-SEAL PRESSURE-SENSITIVE INSIDE CORNER, REFER TO DETAIL FB-15-F.
3. PRESSURE-SENSITIVE CURED COVER STRIP OR OVERLAYMENT STRIP CANNOT BE USED AT CORNERS.
3. PRESSURE-SENSITIVE UNCURED ELASTOFORM FLASHING<sup>®</sup> OR SURE-SEAL INSIDE/OUTSIDE CORNERS MUST BE USED.

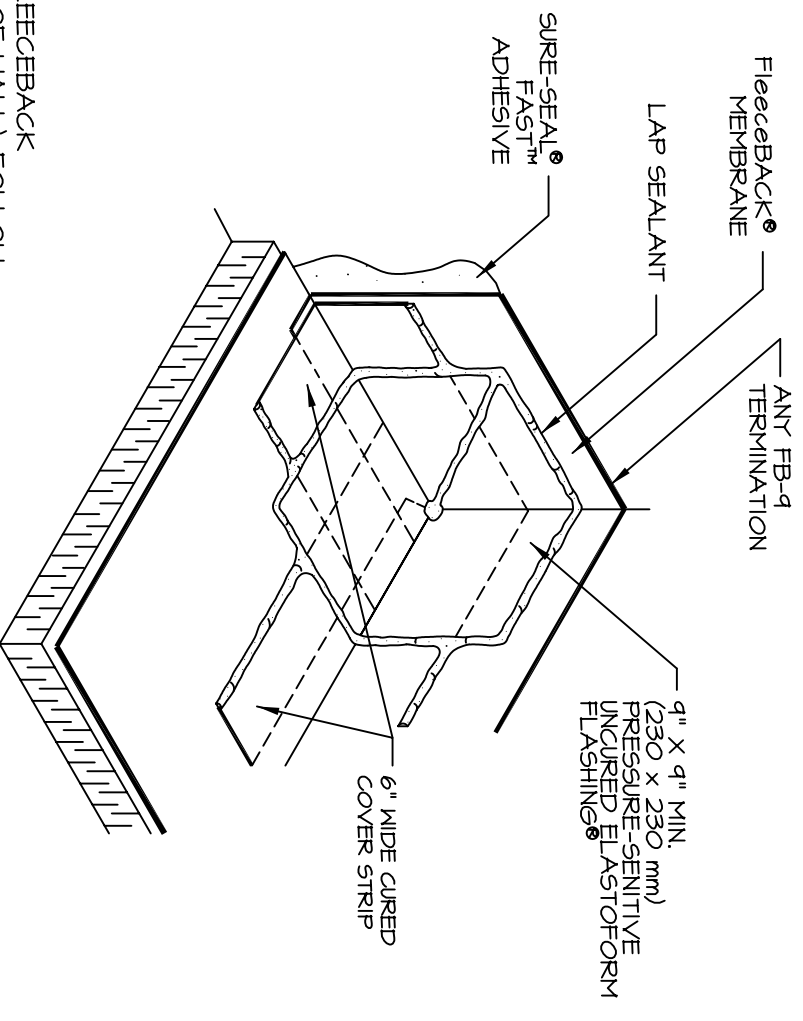

**FB-15-B**

**INSIDE CORNER / SEPARATE FLEECEBACK FLASHING**

**CARLISLE**  
Carlisle Syntec Incorporated