

CARLISLE'S REQUIRED FASTENING PATTERN FOR ORIENTED STRAND BOARD (OSB)

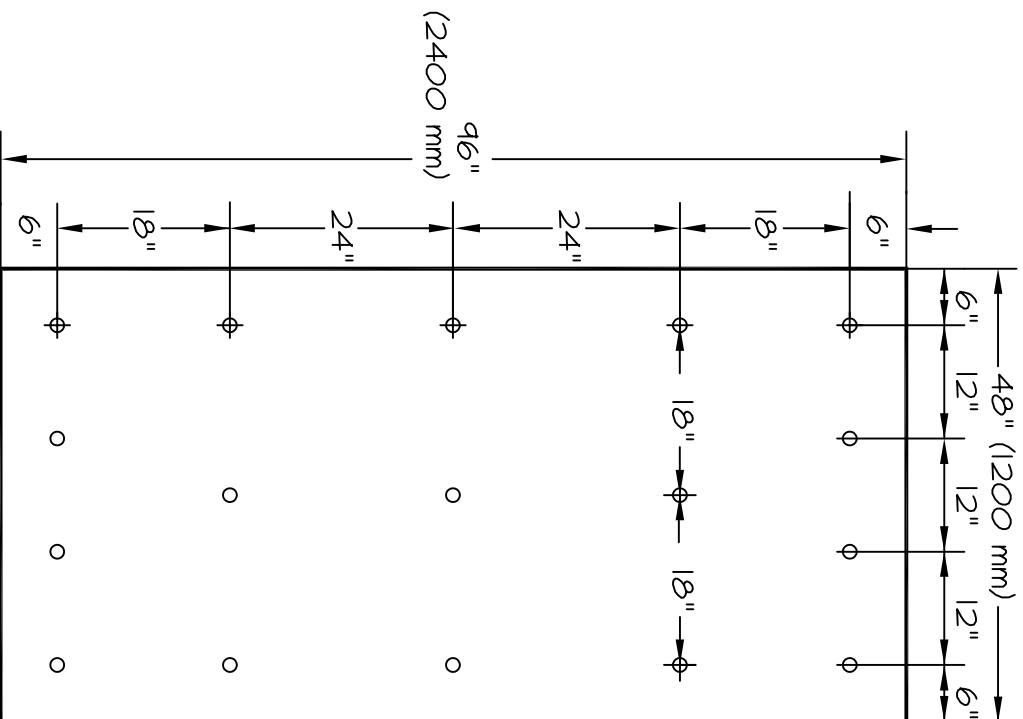

4' (1200 mm) X 8' (2400 mm) ORIENTED STRAND BOARD

FB-27-C

OSB ATTACHMENT

NOTES:

1. JOINTS IN OSB MUST BE STAGGERED WITH JOINTS IN INSULATION BELOW.
2. OSB MUST BE POSITIONED WITH A 1/8" (3 mm) GAP BETWEEN BOARDS.
3. IF A WIND UPLIFT WARRANTY GREATER THAN 72 MPH (115 km/h) IS SPECIFIED, CARLISLE MUST BE CONTACTED PRIOR TO PROJECT BID FOR VERIFICATION OF APPLICABLE REQUIREMENTS.
4. CARLISLE FASTENERS AND 3" (75 mm) DIAMETER INSULATION FASTENING PLATES SHALL BE USED.

