



FLEECEBACK[®]

FULLY ADHERED SYSTEM



TYPICAL APPLICATION

- 1 FleeceBACK 100-, 115-mil or 145-mil membrane
- 2 Factory-Applied Tape
- 3 Insulating FAST Adhesive
- 4 Acceptable Polyisocyanurate Insulation
- 5 Gypsum Deck

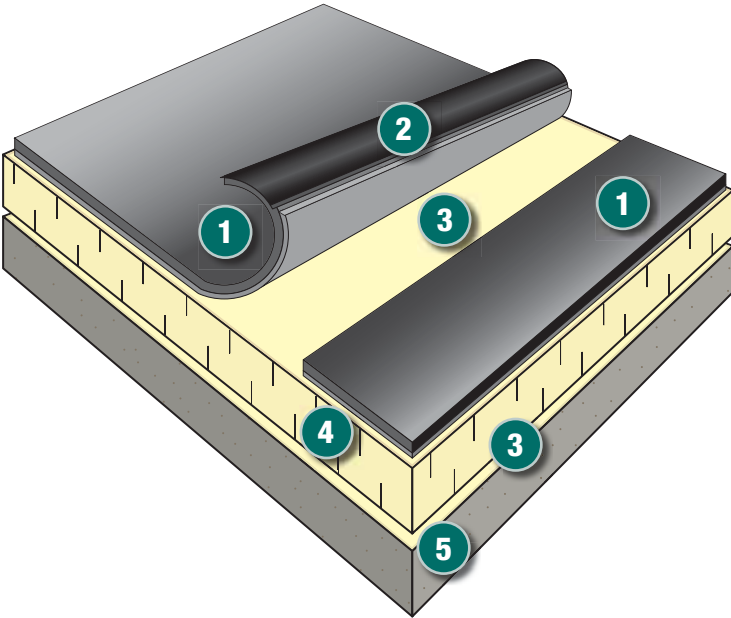

Gypsum Deck - Gypsum decks are an ideal candidate for our FleeceBACK and FAST Adhesive system as they can be installed in a non-penetrating manner which is very quiet. Our two-component FAST Adhesive is spray- or bead-applied in a liquid state that quickly begins to expand and bond to the gypsum deck. The FleeceBACK system also eliminates the need for perimeter fasteners due to the strength of the bond between the FleeceBACK and FAST Adhesive. Some of the system features include:

- Dade County approvals
- Elimination of pre-drilling the deck
- Insulating FAST Adhesive that adds an R-Value of 0.20 to 0.50 per layer while sealing the joints to minimize thermal bridging
- Excellent reroofing options for decks that have previously been penetrated by fasteners
- Factory-Applied Tape for reliable and consistent seaming
- Flexible FAST™ Adhesive offers elongation up to 150% and improves puncture resistance up to 50%



Kirby Hospital

Monticello, IL
30,000 Square Feet
Carlisle FleeceBACK Roofing System
Gypsum Deck

Investing in Roofing Solutions for Over 45 Years

800-479-6832 • P.O. Box 7000 • Carlisle, PA 17013 • Fax: 717-245-7053 • www.carlisle-syntec.com

CARLISLE
Carlisle SynTec



FLEECEBACK[®]

FULLY ADHERED SYSTEM

Description

The FleeceBACK Adhered Roofing System incorporates Sure-Seal[®] (black) or Sure-White[™] (white-on-black) non-reinforced EPDM membrane laminated to non-woven polyester fleece-backing. The membrane is adhered to an acceptable insulation or gypsum decking with a two-component, spray- or bead-applied, low-rise FAST Adhesive. Insulation, if used, can either be adhered with the FAST Adhesive or fastened with an acceptable insulation fastener and plate. Adjoining sheets of membrane are spliced together at a minimum of 3 inches (8 cm) using Factory-Applied Tape.

Quality Assurance

This roofing system must be installed by a Carlisle Authorized Roofing Applicator in compliance with shop drawings as approved by Carlisle. There must be no deviations made from Carlisle's specifications or the approved shop drawings without the PRIOR WRITTEN APPROVAL of Carlisle. Upon completion of the installation, an inspection will be conducted by a Field Service Representative of Carlisle to ascertain that the roofing system has been installed according to Carlisle's specifications and details.

This roofing system meets Underwriters Laboratories (UL) Class A. In addition, when using mechanical fasteners for insulation attachment a Factory Mutual (FM) 1-90 rating can be achieved. For specific code approvals achieved with this system, refer to Carlisle's FleeceBACK Code Approval Guide, FM Approval Guide or UL Fire Resistance and Roofing Materials and Systems Directories.

Carlisle's FleeceBACK System has also passed UL-2218's highest rating, a Class 4, for hail resistance and has passed the National Bureau of Standards NBS-23 Ice Ball Test for up to 3" hail at 32°F.

Product Delivery, Storage and Handling

Deliver materials to the job site in the original, unopened containers labeled with the manufacturer's name, brand name and installation instructions.

Job-site storage temperatures in excess of 90°F (32°C) may affect shelf life of curable materials (i.e., FAST Adhesive - Parts A & B, splicing cement, sealants, cleaners, primers, SecurTAPE, Pourable Sealer, Pressure-Sensitive Flashing and uncured flashing).

When liquid adhesives and sealants are exposed to lower temperatures, restore to a minimum of 60°F (16°C) before use. Do not store containers with opened lids due to loss of solvent which will occur from flash off.

FleeceBACK membrane should be stored in its original plastic wrap and be covered to protect from moisture. Any moisture absorbed by the fleece-backing must be removed by using a wet-vac system, prior to membrane adhesion.

Insulation and underlayment must be stored so it is kept dry and is protected from the elements. Store insulation on a skid and completely cover with a breathable material such as tarp or canvas. If the insulation is lightweight, it should be weighted to prevent possible wind damage.

Job Conditions

Do not apply Sure-Seal FAST Adhesive when surface and/or ambient temperatures are below 25°F (-4°C). When temperatures are between 25°F (-4°C) and 70°F (21°C), the addition of catalyst to FAST Adhesive may be required to speed set-up time.

There is no maximum slope restriction for the application of this roofing system. On Sure-White FleeceBACK Roofing Systems, a slope greater than 1/8 inch per horizontal foot (1 cm/m) is recommended to serve long-term aesthetics.

On retrofit-recover projects, existing roofing material must be investigated and wet material must be removed.

The use of a vapor retarder to protect insulation and reduce moisture accumulation within an insulated roofing assembly should be investigated by the specifier. Consult the latest publications by ASHRAE (American Society of Heating, Refrigerating and Air-Conditioning Engineers, Inc.) and NRCA (National Roofing Contractors Association) for specific information. If a vapor retarder is used and insulation is to be secured with FAST Adhesive, use Carlisle's 725TR Vapor Retarder.

Coordination between various trades is essential to avoid unnecessary rooftop traffic over sections of the roof and to prevent damage to the membrane.

Warranty

A 5- or 10-year Membrane System Warranty, with a wind-speed coverage up to 80 mph (measured at 10 meters above ground level), is available.

A 10-, 15-, 20- or 30-year Total Roofing System Warranty is available on commercial projects which utilize all components manufactured or marketed by Carlisle. The 30-year warranty requires the use of 145-mil FleeceBACK. Upon review by Carlisle, Total System Warranty projects can receive a maximum peak gust wind speed up to 120 mph. Contact Carlisle for specific construction design requirements.

A hail-resistance warranty may be included for up to 1" hail for FleeceBACK 100, up to 2" hail for FleeceBACK 115 and up to 3" hail for 145.

A limited accidental puncture warranty is also available when using FleeceBACK 115 and 145.

Refer to Carlisle's currently published specifications and details for specific requirements concerning the application of this roof.

Roof Deck/Substrate Criteria

A proper substrate shall be provided by the building owner. The structure shall be sufficient to withstand normal construction loads and live loads.

Defects in the roof deck must be reported and documented to the specifier, general contractor and building owner for assessment. The Carlisle Authorized Roofing Applicator shall not proceed unless the defects are corrected.

When fasteners are to be used for insulation attachment, refer to Part I Design Criteria for acceptable fasteners and minimum fastener pullout requirements.

When using FAST Adhesive for membrane and insulation securement directly over a gypsum roof deck (new or tear-off), the deck surface must be cleaned using compressed air, vacuum equipment or hand/power brooms to remove dust, loose dirt or debris. If excessive dust or dirt is present, a primer may be required prior to application of the adhesive. Contact Carlisle for specific primer requirements.

Investing in Roofing Solutions for Over 45 Years

800-479-6832 • P.O. Box 7000 • Carlisle, PA 17013 • Fax: 717-245-7053 • www.carlisle-syntec.com

Carlisle, FleeceBACK, FAST, Flexible FAST, Sure-Seal, Sure-White and SecurTAPE are trademarks of Carlisle.
REPRINT CODE: 600787 - "FB Gypsum Deck Sheet" - 061610 © 2010 Carlisle.

